



Shandong Jinjie Machinery Co.,Ltd

Addr: 253000, #438, North Hubin Road, Tianqu Industrial Park, Dezhou, Shandong, China

Tel: +86-534-2356966 Fax: +86-534-2356966

Email: sales@jinjie-machinery.com; sophie@jinjie-machinery.com

Collet Series

1. JJ-00070 DIN6499B ER Collet

- 1) Made of high quality spring steel
- 2) Powerful clamping ability with high precision and stability
- 3) Used for drilling, boring, milling, tapping, engraving operation. etc
- 4) Adapted for DIN6499B

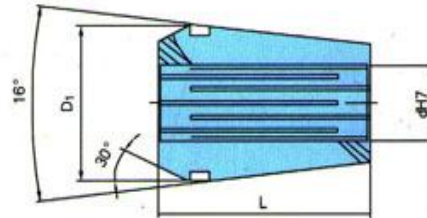

Model	d H7	D	D1	D2	L	L1	L2	L3	Collapsible capacity
ER8	0.5-5.0	8	8.5	6.5	13.5	2.7	1.5	1.2	0.5
ER11	1.0-7.0	11	11.5	9.5	18	3.8	2.5	2	0.5
ER16	1.0-2.0	16	17	13.8	27.5	6.26	4	2.7	0.5
	>2.0-10.0								1
ER20	1.0-2.5	20	21	17.4	31.5	6.36	4.8	2.8	0.5
	>2.5-13.0								1
ER25	1.0-2.5	25	26	22	34	6.66	5	3.1	0.5
	>2.5-16.0								1
ER32	2.0-2.5	32	33	29.2	40	7.16	5.5	3.6	0.5
	>3.5-20.0								1
ER40	3.0-26.0	40	41	36.2	46	7.66	7	4.1	1
ER50	6.0-10.0	50	52	64	60	12.6	8.5	5.5	1
	>10.0-34.0								2



Shandong Jinjie Machinery Co.,Ltd

Addr: 253000, #438, North Hubin Road, Tianqu Industrial Park, Dezhou, Shandong, China

Tel: +86-534-2356966 Fax: +86-534-2356966

Email: sales@jinjie-machinery.com; sophie@jinjie-machinery.com

2. JJ-00078 DIN6388A EOC Collet

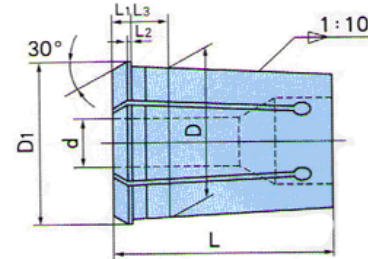

Model	D	D1	d	L	L1	L2	L3
EOC6A	10	11.5	1-6	21	3.5	0.5	4
EOC8A	12.65	14.5	1-8	26	4	0.8	4.5
EOC10A	15.15	17.2	1-10	30	4.5	0.8	4.5
EOC12A	17.75	19.8	1-12	34	5	1.1	4.5
EOC16A	22.65	25.5	2-16	40	5.5	1.2	5.5
EOC20A	27.4	29.8	2-20	45	6	1.35	6
EOC25A	32.9	35.05	2-25	52	6	1.4	6
EOC32A	41.3	43.7	4-32	60	6	1.45	7
EOC40A	49.7	52.2	6-39	68	6	1.45	8
EOC50A	61.1	63.8	8-49	80	7	1.55	9

3. JJ-00080 DIN6388B EOC Collet

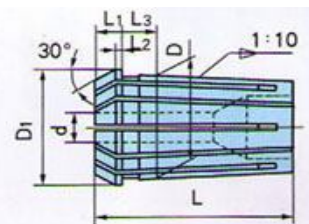

Model	D	D1	d	L	L1	L2	L3
EOC16B	25.5	22.65	2-16	40	5.5	1.2	9.5
EOC20B	29.8	22.4	2-20	45	6	1.35	10
EOC25B	35.05	32.9	2-25	52	6	1.4	10
EOC32B	43.7	41.3	4-32	60	6	1.45	11
EOC40B	52.2	49.7	6-40	68	6	1.45	12
EOC50A	63.8	61.1	8-50	80	7	1.55	13



Shandong Jinjie Machinery Co.,Ltd

Addr: 253000, #438, North Hubin Road, Tianqu Industrial Park, Dezhou, Shandong, China

Tel: +86-534-2356966 Fax: +86-534-2356966

Email: sales@jinjie-machinery.com; sophie@jinjie-machinery.com

4. JJ-00092 JM71 Straight Shank Collet

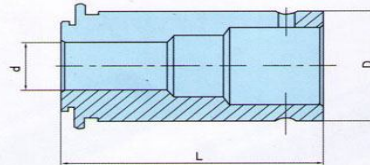
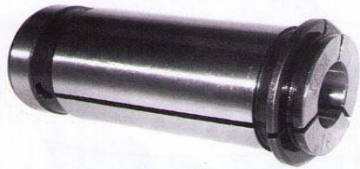

Model	D	d	L
C16	16	4,5,6,8,10,12	45
C20	20	4,5,6,8,10,12,14,16	50
C22	22	4,5,6,8,10,12,14,16	50
C25	25	4,5,6,8,10,12,14,16,18,20	60
C32	32	4,5,6,8,10,12,14,16,18,20,25	65
C40	40	6,8,10,12,14,16,18,20,25,28,30,32	80
C42	42	6,8,10,12,14,16,18,20,25,28,30,32	80

5. JJ-00050 DIN6343 Clamping Collet

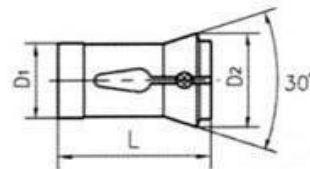
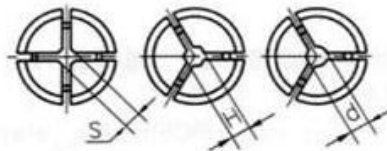

Model	D1(mm)	D2(mm)	L(mm)	Hole size(mm)			Wt(Kg)
				Dmax	Smax	Hmax	
DIN6343-F17.5	17.5	22	51	13	8	10	0.05
DIN6343-F22	22	30	55	16	11	13	0.09
DIN6343-F27	27	38	72.7	22	15	19	0.1
DIN6343-F28	28	38	70	22	15	19	0.12
DIN6343-F32	32	45	75	26	18	22	0.27
DIN6343-F35	35	48	80	30	21	26	0.35
DIN6343-F42	42	55	94	36	25	30	0.49
DIN6343-F48	48	60	94	42	29	36	0.57
DIN6343-F56	56	68	94	50	35	42	0.65
DIN6343-F66	66	84	110	60	42	52	1.16



Shandong Jinjie Machinery Co.,Ltd

Addr: 253000, #438, North Hubin Road, Tianqu Industrial Park, Dezhou, Shandong, China

Tel: +86-534-2356966 Fax: +86-534-2356966

Email: sales@jinjie-machinery.com; sophie@jinjie-machinery.com

6. JJ-00068 TG Collet



Tpye	Model	D	L	d
TG-01	TG75-d	27	46.9	2-20(mm); 1/16-25/32(in)
TG-02	TG100-d	35	60.5	3-25(mm); 1/8-1(in)
TG-03	TG150-d	50.8	76.2	6-40(mm); 1/4-1(in); 1-1/16~1-9/16 (in)

7. JJ-000710 ER32C Collet

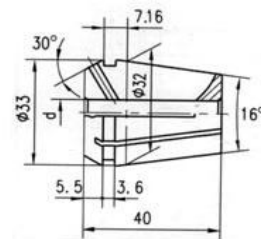

Model	d(mm)	Model	d(mm)	Model	d(mm)
ER32C030M	3	ER32C090M	9	ER32C150M	15
ER32C040M	4	ER32C100M	10	ER32C160M	16
ER32C050M	5	ER32C110M	11	ER32C170M	17
ER32C060M	6	ER32C120M	12	ER32C180M	18
ER32C070M	7	ER32C130M	13	ER32C190M	19
ER32C080M	8	ER32C140M	14	ER32C200M	20



Shandong Jinjie Machinery Co.,Ltd

Addr: 253000, #438, North Hubin Road, Tianqu Industrial Park, Dezhou, Shandong, China

Tel: +86-534-2356966 Fax: +86-534-2356966

Email: sales@jinjie-machinery.com; sophie@jinjie-machinery.com

8. JJ-00064 Spring Collet

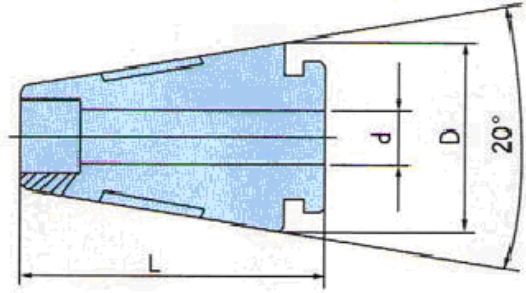

Tpye	Model	D	L	d
Spring-01	17.5-d	17.5	24	2, 3, 4, 5, 6, 8, 1/16, 1/8, 3/16, 1/4, 5/16
Spring-02	20.3-d	20.3	30	2, 3, 4, 6, 8, 10, 1/16, 1/8, 3/16, 1/4, 5/16, 3/8

9. JJ-00030 Sharpener Collet

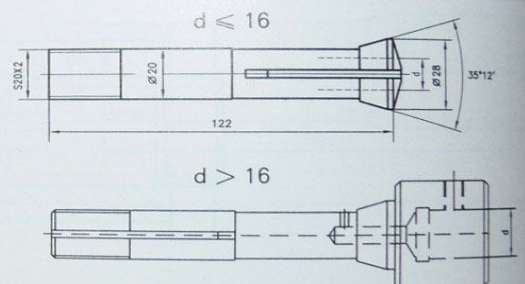
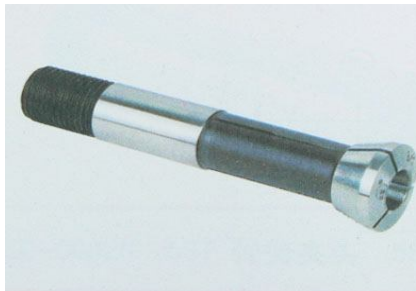

Model	d(mm)	Model	d(mm)	Model	d(in)	Model	d(in)
SC-3	3	SC-14	14	SC-1/8	1/8	SC-9/16	9/16
SC-4	4	SC-15	15	SC-3/16	3/16	SC-5/8	5/8
SC-5	5	SC-16	16	SC-1/4	1/4	SC-3/4	3/4
SC-6	6	SC-18	18	SC-5/16	5/16	SC-7/8	7/8
SC-8	8	SC-20	20	SC-3/8	3/8	SC-1	1
SC-10	10	SC-25	25	SC-7/16	7/16	SC-1-1/8	1-1/8
SC-12	12	SC-28	28	SC-1/2	1/2		



Shandong Jinjie Machinery Co.,Ltd

Addr: 253000, #438, North Hubin Road, Tianqu Industrial Park, Dezhou, Shandong, China

Tel: +86-534-2356966 Fax: +86-534-2356966

Email: sales@jinjie-machinery.com; sophie@jinjie-machinery.com

10. JJ-00002 R8 Collet

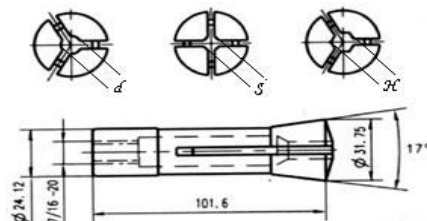

Tpye	Model	Shape	d/S/H	
			mm	in
R8-01	R8-R	Round	1-22	1/32-7/8
R8-02	R8-S	Square	3-13	3/3-1/2
R8-03	R8-H	Hex	3-16	3/32-5/8

11. JJ-00060 DA Collet

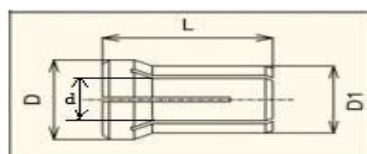

Model	D(mm)	M(mm)	D1(mm)	d	
				mm	in
DA10	19.5	36.5	16.5	2-12.5	1/16-1/2
DA18	26.045	41.7	22.08	2-18	1/16-45/64
DA20	13.6	30.4	11.43	1-8	3/64-5/16
DA30	9.5	25.4	7.62	1.5-6	3/64-15/64



Shandong Jinjie Machinery Co.,Ltd

Addr: 253000, #438, North Hubin Road, Tianqu Industrial Park, Dezhou, Shandong, China

Tel: +86-534-2356966 Fax: +86-534-2356966

Email: sales@jinjie-machinery.com; sophie@jinjie-machinery.com

12. JJ-00106 Keyless Drill Chuck with Thread Mounted

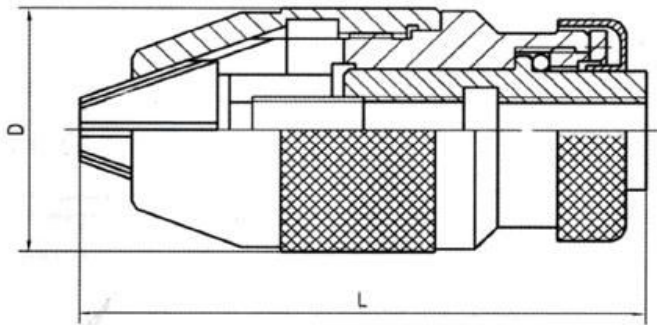

Model	Capacity	Mount	D(mm)
J0306	0.5-6mm	M10*1	34
J0306A	1/64"-1/4"	3/8"-24UNF	
J0308	0.5-8mm	M10*1	40
J0308A	1/64"-5/16"	3/8"-24UNF	
J0308B	0.5-8mm	N12*1.25	
J0308C	1/64"-5/16"	1/2"-20UNF	42
J0310	1-10mm	M10*1	
J0310A	1/32"-3/8"	3/8"-24UNF	
J0310B	1-10mm	M12*1.25	
J0310C	1/32"-3/8"	1/2"-20UNF	44
J0313	1-13mm	M10*1	
J0313A	1/32"-1/2"	3/8"-24UNF	
J0313B	1-13mm	M12*1.25	
J0313C	1/32"-1/2"	1/2"-20UNF	48
J0316	3-16mm	M12*1.25	
J0316A	1/8"-5/8"	1/2"-20UNF	
J0316B	3-16mm	M16*1.5	
J0316C	1/8"-5/8"	5/8"-16UNF	



Shandong Jinjie Machinery Co.,Ltd

Addr: 253000, #438, North Hubin Road, Tianqu Industrial Park, Dezhou, Shandong, China

Tel: +86-534-2356966 Fax: +86-534-2356966

Email: sales@jinjie-machinery.com; sophie@jinjie-machinery.com

13. JJ-00104 Keyless Drill Chuck with Taper Mounted

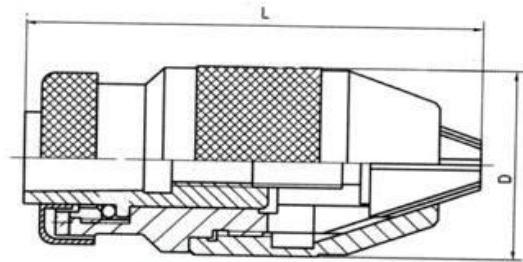

Model	Capacity	Mount	D(mm)	L(mm)	Run-out (mm)		
					P	D	M
J0106	0.5-6mm	B10	34	72	0.12	0.16	none
J0206	1/64"-1/4"	JT1					
J0108	0.5-8mm	B12	42	82			
J0208	1/64"-5/16"	JT2					
J0110	1-10mm	B12	44	88			0.06
J0210	1/32"-3/8"	JT2					
J0210A		JT33					
J0113	1-13mm	B16	49	97			
J0113A		B16					
J0213	1/32"-1/2"	JT33	54	100			
J0213A		JT6					
J0116A	3-16mm	B16	54	110			
J0116		B18					
J0216	1/8"-5/8"	JT6	60	125	0.18	0.25	none
J0216A		JT3					
J0120	5-20mm	B22	60	125			
J0220	3/16"-3/4"	JT3					



Shandong Jinjie Machinery Co.,Ltd

Addr: 253000, #438, North Hubin Road, Tianqu Industrial Park, Dezhou, Shandong, China

Tel: +86-534-2356966 Fax: +86-534-2356966

Email: sales@jinjie-machinery.com; sophie@jinjie-machinery.com

Collet Set

14. JJ-00076 Milling Chuck Set

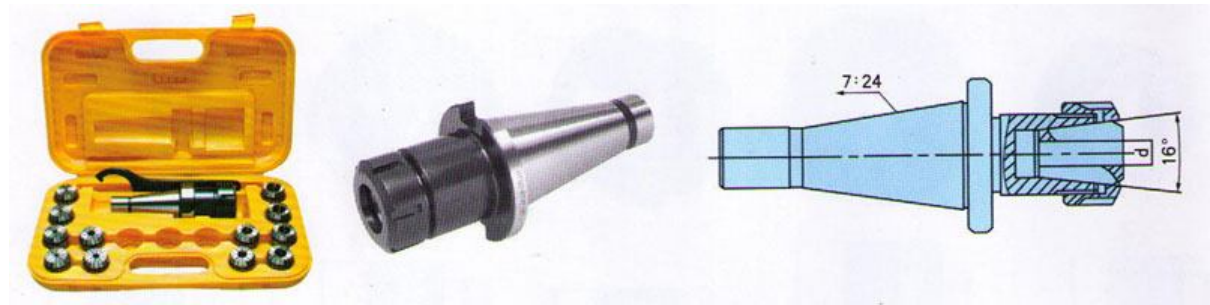

Model	Pcs/set	d		Shank	Wt(kg)
		mm	in		
30ER16/8Pcs	8	2,3,4,5,6,7,8,10	3/32, 1/8, 3/16, 7/32, 1/4, 5/16, 11/32, 3/8	7:24-30	0.76
40ER16/8Pcs				7:24-40	1.3
50ER16/8Pcs				7:24-50	2.48
30ER25/6Pcs	6	4,6,8,10,12,16	1/8, 3/16, 3/8, 1/2, 5/8	7:24-30	1.08
40ER25/6Pcs				7:24-40	1.35
50ER25/6Pcs				7:24-50	2.78
30ER25/10Pcs	10	3,4,5,6,8,10, 12,14,15,16	3/32, 1/8, 3/16, 1/4, 3/8, 5/16, 7/16, 1/2, 9/16, 5/8	7:24-30	1.37
40ER25/10Pcs				7:24-40	1.72
50ER25/10Pcs				7:24-50	3.11
30ER32/6Pcs	6	6,8,10,12,16,20	1/4, 5/16, 3/8, 1/2, 5/8, 3/4	7:24-30	1.66
40ER32/6Pcs				7:24-40	2
50ER32/6Pcs				7:24-50	3.38
30ER32/12Pcs	12	3,4,5,6,8,10,12, 14,15,16,18,22	3/32, 1/8, 3/16, 1/4, 5/16, 3/8, 7/16, 1/2, 9/16, 5/8, 11/16, 3/4	7:24-30	2.74
40ER32/12Pcs				7:24-40	2.94
50ER32/12Pcs				7:24-50	4.43
30ER40/8Pcs	8	3,5,8,12,15, 18,22,26	1/8, 1/4, 3/8, 1/2, 5/8, 3/4, 7/8, 1	7:24-30	2.77
40ER40/8Pcs				7:24-40	2.98
50ER40/8Pcs				7:24-50	4.37
30ER40/12Pcs	15	3,4,5,6,8,10, 12,14,15,16, 18,20,22,24,26	1/8, 3/16, 1/4, 5/16, 3/8, 7/16, 1/2, 9/16, 5/8, 11/16, 3/4, 13/16, 7/8, 15/16, 1	7:24-30	4.25
40ER40/12Pcs				7:24-40	4.6
50ER40/12Pcs				7:24-50	5.99

<http://www.jinjie-machinery.com/>



Shandong Jinjie Machinery Co.,Ltd

Addr: 253000, #438, North Hubin Road, Tianqu Industrial Park, Dezhou, Shandong, China

Tel: +86-534-2356966 Fax: +86-534-2356966

Email: sales@jinjie-machinery.com; sophie@jinjie-machinery.com

15. JJ-J002 R8 Body and ER Set

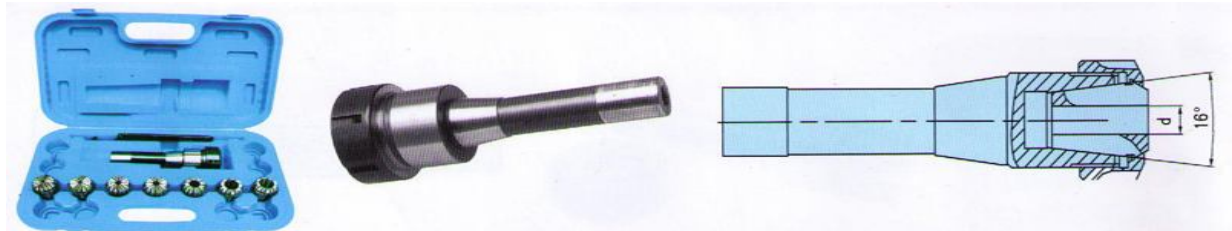

Model	Pcs/set	d		Shank	Wt(kg)
		mm	in		
R8-ER16/8Pcs	8	2,3,4,5,6,7,8,10	3/32,1/8,3/16, 7/32,1/4,5/16,11/32,3/8	R8	0.92
R8-ER25/6Pcs	6	4,6,8,10,12,16	1/8,3/16,5/16,3/8,1/2,5/8	R8	1.2
R8-ER25/10Pcs	10	3,4,5,6,8,10,12, 14,15,16	3/32,1/8,3/16,1/4,3/8, 5/16,7/16,1/2,9/16,5/8,	R8	1.53
R8-ER32/6Pcs	6	6,8,10,12,16,20	1/4,5/16,3/8, 1/2,5/8,3/4	R8	1.81
R8-ER32/12Pcs	12	3,4,5,6,8,10, 12,14,15,16,18,20	3/32,1/8,3/16,1/4,3/8,5/16, 7/16,1/2,9/16,5/8,11/16,3/4	R8	2.89
R8-ER40/8Pcs	8	3,5,8,12, 15,18,22,26	1/8,1/4,3/8,1/2, 5/8,3/4,7/8,1	R8	2.93
R8-ER40/15Pcs	15	3,4,5,6,8,10, 12,14,15,16,18, 20,22,24,26	1/8,3/16,1/4,5/16, 3/8,7/16,1/2,9/16,5/8,11/16, 3/4,13/16,7/8,15/16,1	R8	4

Taper of collet Chuck	Thread of draw bar	
R8	7/16" -20UNF	
7:24-30	M12x1.75	1/2"-13UNC
7:24-40	M16x2.0	5/8"-11UNC
7:24-50	M24x3.0	1"-8UNC
MS2	M10x1.5	3/8"-16UNC
MS3	M12x1.75	1/2"-13UNC
MS4	M16x2.0	5/8"-11UNC
MS5	M20x2.5	3/4"-10UNC



Shandong Jinjie Machinery Co.,Ltd

Addr: 253000, #438, North Hubin Road, Tianqu Industrial Park, Dezhou, Shandong, China

Tel: +86-534-2356966 Fax: +86-534-2356966

Email: sales@jinjie-machinery.com; sophie@jinjie-machinery.com

16. JJ-J003 ER Collet Set (Aluminum box)

Model	Pcs/Set	d(mm)	Remark
ER8	9	1-5	 <p>We can make the box according to your order, please feel free to tell us which models you would like in one case.</p>
ER11	13	1-7	
ER16	10	1-10	
ER20	12	2-13	
ER25	15	2-16	
ER32	18	3-20	
ER40	23	4-26	
ER50	29	6-34	