



Shandong Jinjie Machinery Co.,Ltd

Addr: 253000, #438, North Hubin Road, Tianqu Industrial Park, Dezhou, Shandong, China

Tel: +86-534-2356966 Fax: +86-534-2356966

Email: sales@jinjie-machinery.com; sophie@jinjie-machinery.com

Drill Chuck Arbor Series

1. JJ-00184 R8 Drill Chuck Arbor

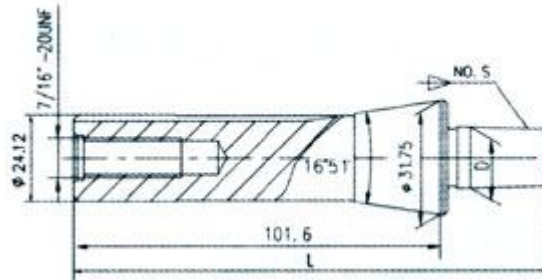

Model	D (mm)	L (mm)	Wt (kg)	Model	D (mm)	L (mm)	Wt (kg)
R8-J0	6.35	117	0.393	R8-J5	35.89	154	0.742
R8-J1	9.754	122	0.409	R8-B6	6.35	118.5	0.25
R8-J2S	13.94	125	0.4	R8-B10	10.094	124	0.368
R8-J2	14.199	128	0.414	R8-B12	12.065	128	0.408
R8-J33	15.85	132	0.414	R8-B16	15.733	135	0.44
R8-J6	17.17	132	0.428	R8-B18	17.78	143	0.545
R8-J3	20.599	137	0.456	R8-B22	21.739	152	0.514
R8-J4	28.55	148	0.6	R8-B24	23.825	162	0.567



Shandong Jinjie Machinery Co.,Ltd

Addr: 253000, #438, North Hubin Road, Tianqu Industrial Park, Dezhou, Shandong, China

Tel: +86-534-2356966 Fax: +86-534-2356966

Email: sales@jinjie-machinery.com; sophie@jinjie-machinery.com

2. JJ-00188 7:24 Drill Chuck Arbor

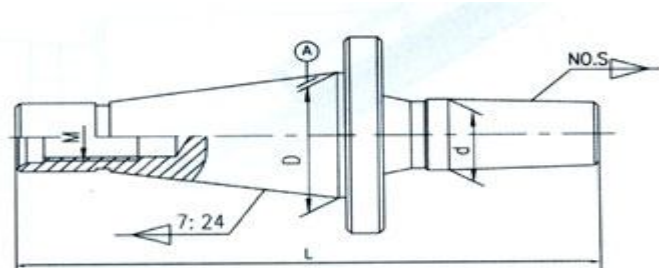

Model	D(mm)	d(mm)	L(mm)	M	Wt(kg)	Model	d (mm)	D(mm)	l(mm)	M	Wt(kg)		
ISO30-J0	31.75	6.35	99	M12	0.313	ISO50-B6	17.17	69.85	184	M24	2.739		
ISO30-J1		9.754	106		0.326	ISO50-B3	20.599		191		2.777		
ISO30-J2S		13.94	113		0.341	ISO50-B4	28.55		202		2.953		
ISO30-J2		14.199	122		0.349	ISO50-B5	35.89		208		3.178		
ISO30-J33		15.85	122		0.377	ISO30-B10	10.94	31.75	104	M12	0.325		
ISO30-J6		17.17	123		0.388	ISO30-B12	12.065		108		0.33		
ISO30-J3		20.599	122		0.426	ISO30-B16	15.733		116		0.372		
ISO30-J4		28.55	122		0.602	ISO30-B18	17.78		124		0.393		
ISO30-J5		35.89	123		0.827	ISO30-B22	21.793		133		0.46		
ISO40-J0		6.35	136		0.789	ISO30-B24	23.825		143		0.518		
ISO40-J1	44.45	9.754	145	M16	0.797	ISO40-B10	10.094	44.45	132	M16	0.801		
ISO40-J2S		13.94	122		0.817	ISO40-B12	12.065		136		0.809		
ISO40-J2		14.199	136		0.829	ISO40-B16	15.733		143		0.848		
ISO40-J33		15.85	141		0.853	ISO40-B18	17.78		151		0.869		
ISO40-J6		17.17	145		0.864	ISO40-B22	21.793		160		0.936		
ISO40-J3		20.599	150/145		0.902	ISO40-B24	23.825		169		0.994		
ISO40-J4		28.55	165		1.028	ISO50-B10	10.094		69.85		170	M24	2.684
ISO40-J5		35.89	170		1.303	ISO50-B12	12.065				174		2.676
ISO50-J1		9.754	175		2.672	ISO50-B16	15.733				182		2.723
ISO50-J2S	13.94	177	2.692	ISO50-B18	17.78	195	2.744						
ISO50-J2	14.199	180	2.704	ISO50-B22	21.793	200	2.811						
ISO50-J33	15.85	184	2.728	ISO50-B24	23.825	215	2.869						



Shandong Jinjie Machinery Co.,Ltd

Addr: 253000, #438, North Hubin Road, Tianqu Industrial Park, Dezhou, Shandong, China

Tel: +86-534-2356966 Fax: +86-534-2356966

Email: sales@jinjie-machinery.com; sophie@jinjie-machinery.com

3. JJ-00192 Morse Taper Drill Chuck Arbor with Tang

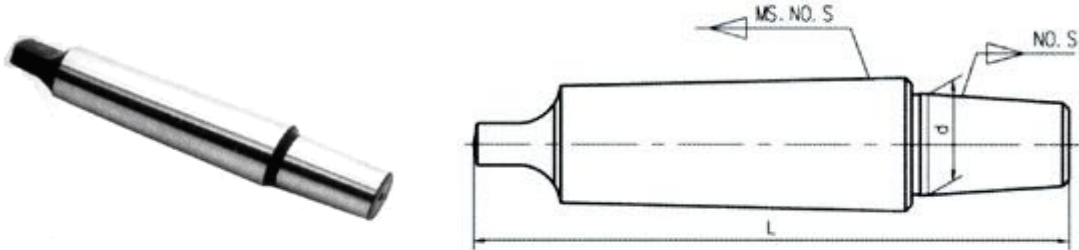

Model	d (mm)	L (mm)	Model	d (mm)	L (mm)	Model	d (mm)	L (mm)
MS0-B6	6.35	75	MS2-B22	21.793	128	MS4-B18	17.78	164
MS0-B10	10.094	80	MS2-B24	23.825	138	MS4-B22	21.793	172
MS0-B12	12.065	84	MS2-B18S	17.431	113	MS4-B24	23.825	182
MS0-B16	15.733	91	MS2-J0	6.35	94	MS4-J0	6.35	138
MS0-B18	17.78	99	MS2-J1	9.754	100	MS4-J1	9.754	143
MS0-B22	21.793	108	MS2-J2	14.199	105	MS4-J2	14.199	149
MS0-B24	23.825	118	MS2-J3	20.599	114	MS4-J3	20.599	158
MS0-J0	6.35	73	MS2-J4	28.55	125	MS4-J4	28.55	169
MS0-J3	20.599	93	MS2-J5	35.89	130	MS4-J5	35.89	174
MS0-J33	15.85	88	MS2-J6	17.17	108	MS4-J6	17.17	152
MS1-B10	10.094	86	MS2-J33	15.85	108	MS4-J33	15.85	152
MS1-B12	12.065	90	MS3-B10	10.094	120	MS4-B10	10.094	177
MS1-B16	15.733	97	MS3-B12	12.065	124	MS4-B12	12.065	181
MS1-B18	17.78	105	MS3-B16	15.733	131	MS4-B16	15.733	188
MS1-B22	21.793	114	MS3-B18	17.78	139	MS4-B18	17.78	196
MS1-B24	23.825	124	MS3-B22	21.793	147	MS4-B22	21.793	204
MS1-J0	6.35	79	MS3-B24	23.825	157	MS4-B24	23.825	214
MS1-J1	9.754	85	MS3-J0	6.35	113	MS5-J0	6.35	170
MS1-J2	14.199	90	MS3-J1	9.754	118	MS5-J1	9.754	175
MS1-J3	20.599	99	MS3-J2	14.199	124	MS5-J2	14.199	181
MS1-J4	28.55	110	MS3-J3	20.599	133	MS5-J3	20.599	190
MS1-J5	35.89	116	MS3-J4	28.55	144	MS5-J4	28.55	201
MS1-J6	17.17	94	MS3-J5	35.89	149	MS5-J5	35.89	206
MS1-J33	15.85	94	MS3-J6	17.17	127	MS5-J6	17.17	184
MS2-B10	10.094	101	MS3-J33	15.85	127	MS5-J33	15.85	184
MS2-B12	12.065	105	MS4-B10	10.094	145	MS6-J16	15.733	250
MS2-B16	15.733	112	MS4-B12	12.065	149	MS6-J3	20.599	252
MS2-B18	17.78	120	MS4-B16	15.733	156	MS6-J6	17.17	246



Shandong Jinjie Machinery Co.,Ltd

Addr: 253000, #438, North Hubin Road, Tianqu Industrial Park, Dezhou, Shandong, China

Tel: +86-534-2356966 Fax: +86-534-2356966

Email: sales@jinjie-machinery.com; sophie@jinjie-machinery.com

4. JJ-001932 Morse Drill Chuck Arbor

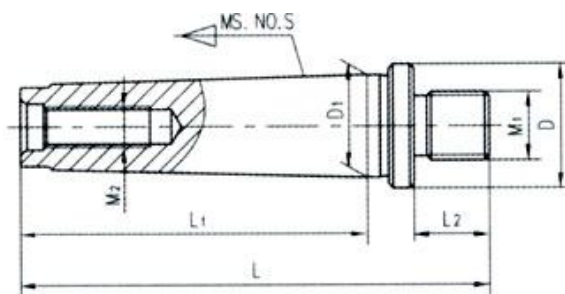

Model	d (mm)	MS. NO. W	L (mm)	L1 (mm)	L2 (mm)	D1 (mm)	M1	M2
MS2W-3/8-24UNF	24	MS2W	88	64	13.5	17.78	3/8-24UNF	M10×1.5
MS2W-1/2-20UNF	27		15.6		1/2-20UNF			
MS2W-3/8-24UNF	24	MS3W	105	81	13.5	23.825	3/8-24UNF	M1×21.75
MS2W-1/2-20UNF	27		15.5		1/2-20UNF			

5. JJ-001936 Straight Drill Chuck Arbor

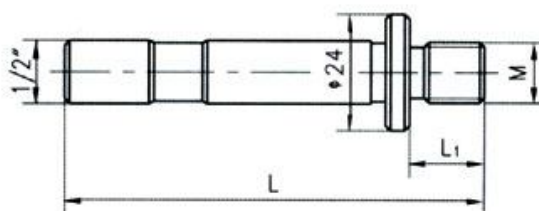

Model	L	L1	M
1/2-3/8-24	82	13.5	3/8-24UNF
1/2-1/2-20	84	15.5	1/2-20UNF



Shandong Jinjie Machinery Co.,Ltd

Addr: 253000, #438, North Hubin Road, Tianqu Industrial Park, Dezhou, Shandong, China

Tel: +86-534-2356966 Fax: +86-534-2356966

Email: sales@jinjie-machinery.com; sophie@jinjie-machinery.com

6. JJ-00380 Shell Mill Arbor

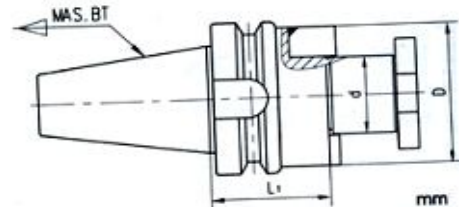

Model	D	Wt (Kg)	Model	D	Wt (kg)
BT * d-L1			BT * d-L1		
BT30*16-60	32	1	BT45*22-60	40	2.6
BT30*22-60	40	1.3	BT45*27-60	48	2.8
BT30*27-60	48	1.5	BT45*27-100		3.1
BT30*32-60	58	1.8	BT45*40-100	70	3.4
BT30*40-60	70	2.2	BT45*40-105		3.5
BT30*50-70	90	4.5	BT50*16-60	32	3.6
BT40*16-45	32	1	BT50*16-75		3.9
BT40*16-60		1.3	BT50*16-120		4.3
BT40*16-120		1.7	BT50*22-60	5	
BT40*22-45	40	1.5	BT50*22-75	40	4
BT40*22-60		1.7	BT50*22-100		4.5
BT40*22-100		3	BT50*22-120		5
BT40*22-120		3.6	BT50*27-60		48
BT40*27-45	48	1.5	BT50*27-105	4	
BT40*27-60		1.6	BT50*32-60	58	4.5
BT40*27-75		1.8	BT50*32-75		1.6
BT40*27-105		2.1	BT50*32-105		1.8
BT40*27-120		2.3	BT50*40-60	70	2.2
BT40*32-45	58	1.2	BT50*40-75		3.6
BT40*32-60		1.5	BT50*40-90		3.7
BT40*32-75		1.8	BT50*40-100		3.75
BT40*32-120		2.8	BT50*40-105	3.8	
BT40*40-60	70	2	BT50*50-60	90	4
BT40*40-75		2.2	BT50*50-70		4.2
BT40*50-70	90	2.5	BT50*50-120		4.4



Shandong Jinjie Machinery Co.,Ltd

Addr: 253000, #438, North Hubin Road, Tianqu Industrial Park, Dezhou, Shandong, China

Tel: +86-534-2356966 Fax: +86-534-2356966

Email: sales@jinjie-machinery.com; sophie@jinjie-machinery.com

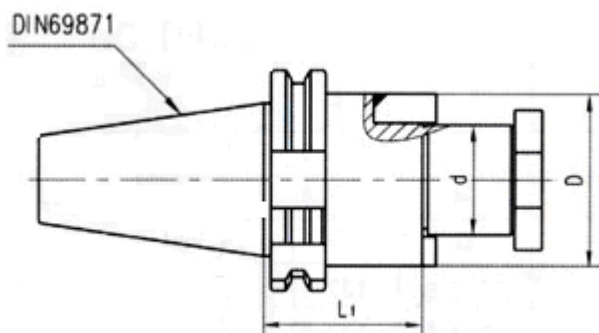

Model	D	Wt (Kg)	Model	D	Wt (kg)
DIN69871 * d-L1			DIN69871 * d-L1		
DIN69871. 30*16-60	32	1	DIN69871. 40*32-60	58	4.5
DIN69871. 30*22-60	40	1.3	DIN69871. 40*40-60	70	4.8
DIN69871. 30*27-60	48	1.5	DIN69871. 40*50-70	90	3.7
DIN69871. 30*32-60	58	1.8	DIN69871. 50*16-60	32	3.8
DIN69871. 30*40-60	70	2.2	DIN69871. 50*22-60	40	4
DIN69871. 30*50-70	90	3.2	DIN69871. 50*27-60	48	4.8
DIN69871. 40*16-60	32	1.2	DIN69871. 50*32-60	58	3.8
DIN69871. 40*22-60	40	1.3	DIN69871. 50*40-60	70	4.5
DIN69871. 40*27-60	48	1.4	DIN69871. 50*50-70	90	4
DIN69871. 40*27-75		1.6			



Shandong Jinjie Machinery Co.,Ltd

Addr: 253000, #438, North Hubin Road, Tianqu Industrial Park, Dezhou, Shandong, China

Tel: +86-534-2356966 Fax: +86-534-2356966

Email: sales@jinjie-machinery.com; sophie@jinjie-machinery.com

7. JJ-00382 Drill Chuck Arbor

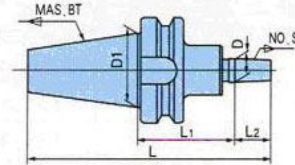

Model	L ₂	L	D	D ₁	Drawbar thread	Wt(kg)
BT30-J1-45	16.669	110	9.754	31.75	M12	0.6
BT30-J2-45	22.225	115.6	14.199	31.75	M12	0.7
BT30-J2S-45	19.05	112.4	13.94	31.75	M12	0.7
BT30-J3-45	30.956	124.4	20.599	31.75	M12	0.8
BT30-J4-45	42.069	135.4	28.55	31.75	M12	0.85
BT30-J5-45	47.625	141	35.89	31.75	M12	0.9
BT30-J6-45	25.4	118.8	17.17	31.75	M12	0.75
BT30-J33-40	25.4	113.8	15.85	31.75	M12	0.75
BT30-J33-45	25.4	118.8	15.85	31.75	M12	0.75
BT30-B10-45	14.5	107.9	10.094	31.75	M12	0.6
BT30-B12-45	18.5	111.9	12.065	31.75	M12	0.6
BT30-B16-45	24	117.4	15.733	31.75	M12	0.7
BT30-B18-45	32	125.4	17.78	31.75	M12	0.82
BT40-J1-45	16.669	128.1	9.754	44.45	M16	1.15
BT40-J2-45	22.225	132.6	14.199	44.45	M16	1.25
BT40-J2S-45	19.05	129.4	13.94	44.45	M16	1.2
BT40-J3-45	30.596	141.4	20.599	44.45	M16	1.45
BT40-J4-45	42.069	152.5	28.55	44.45	M16	1.55
BT40-J5-45	47.625	158	35.89	44.45	M16	1.6
BT40-J6-45	25.4	135.8	17.17	44.45	M16	1.3
BT40-J33-45	25.4	135.8	15.85	44.45	M16	1.3
BT40-B10-45	14.5	124.9	10.094	44.45	M16	1.4
BT40-B10-120	14.5	199.9	10.094	44.45	M16	1.76
BT40-B12-45	18.5	128.9	12.065	44.45	M16	1.34
BT40-B16-32	24	121.4	15.733	44.45	M16	1.4
BT40-B16-45	24	134.4	15.733	44.45	M16	1.45
BT40-B16-75	24	164.4	15.733	44.45	M16	1.55
BT40-B16-90	24	179.4	15.733	44.45	M16	1.4



Shandong Jinjie Machinery Co.,Ltd

Addr: 253000, #438, North Hubin Road, Tianqu Industrial Park, Dezhou, Shandong, China

Tel: +86-534-2356966 Fax: +86-534-2356966

Email: sales@jinjie-machinery.com; sophie@jinjie-machinery.com

BT40-B18-45	32	142.4	17.78	44.45	M16	1.7
BT40-B18-75	32	172.4	17.78	44.45	M16	1.76
BT45-B16-90	24	196.8	15.733	51.75	M20	2.3
BT45-B16-100	24	206.8	15.733	51.75	M20	2.4
BT50-J1-45	16.669	163.5	9.754	69.85	M24	3.6
BT50-J2-45	22.225	169	14.199	69.85	M24	3.95
BT50-J2S-45	19.05	165.9	13.94	69.85	M24	3.9
BT50-J3-45	30.956	177.8	20.599	69.85	M24	3.7
BT50-J4-45	42.069	188.9	28.55	69.85	M24	3.75
BT50-J5-45	47.625	194.4	32.89	69.85	M24	3.8
BT50-J6-45	25.4	172.2	17.17	69.85	M24	4
BT50-J33-45	25.4	172.2	15.85	69.85	M24	4
BT50-B10-45	14.5	161.3	10.094	69.85	M24	3.6
BT50-B10-100	14.5	216.3	10.094	69.85	M24	3.8
BT50-B12-45	18.5	165.3	12.065	69.85	M24	3.6
BT50-B16-45	24	170.8	15.733	69.85	M24	3.65
BT50-B16-60	24	185.8	15.733	69.85	M24	3.7
BT50-B16-75	24	200.8	15.733	69.85	M24	3.74
BT50-B16-90	24	215.8	15.733	69.85	M24	3.78
BT50-B18-45	32	178.8	17.78	69.85	M24	3.7



Shandong Jinjie Machinery Co.,Ltd

Addr: 253000, #438, North Hubin Road, Tianqu Industrial Park, Dezhou, Shandong, China

Tel: +86-534-2356966 Fax: +86-534-2356966

Email: sales@jinjie-machinery.com; sophie@jinjie-machinery.com

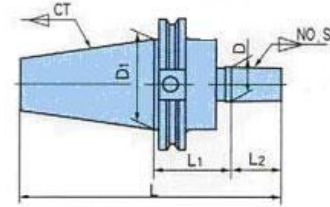

Model	L ₂	L	D	D ₁	Drawbar thread
CT40-J2-45	22.225	135.5	14.199	44.45	5/8"-11
CT40-J3-45	30.956	144.2	20.599	44.45	5/8"-11
CT40-J4-45	42.069	155.3	28.55	44.45	5/8"-11
CT40-J6-45	25.4	138.65	17.17	44.45	5/8"-11
CT40-J33-45	25.4	138.65	15.85	44.45	5/8"-11
CT40-J16-45	24	137.25	15.733	44.45	5/8"-11
CT40-J18-45	32	145.25	17.78	44.45	5/8"-11
CT45-J1-45	16.669	144.2	9.754	57.15	3/4"-10
CT45-J2-45	22.225	150	14.199	57.15	3/4"-10
CT45-J3-45	30.956	158.5	20.599	57.15	3/4"-10
CT45-J4-45	42.069	169.6	28.55	57.15	3/4"-10
CT45-J5-45	47.625	175.2	35.89	57.15	3/4"-10
CT45-J6-45	25.4	153	17.17	57.15	3/4"-10
CT45-J33-45	25.4	153	15.85	57.15	3/4"-10
CT45-B10-45	14.5	142	10.094	57.15	3/4"-10
CT45-B12-45	18.5	146	12.065	57.15	3/4"-10
CT45-B16-32	24	138.6	15.733	57.15	3/4"-10
CT45-B16-45	24	151.6	15.733	57.15	3/4"-10
CT45-B18-45	32	159.6	17.78	57.15	3/4"-10
CT50-J2-45	22.228	168.85	14.199	69.85	1"-8
CT50-J3-45	30.956	177.56	20.599	69.85	1"-8
CT50-J4-45	42.069	188.67	28.55	69.85	1"-8
CT50-J5-45	147.625	194.23	35.89	69.85	1"-8
CT50-J6-45	25.4	172	17.17	69.85	1"-8
CT50-J33-45	25.4	172	15.85	69.85	1"-8
CT50-B10-45	14.5	161.1	10.094	69.85	1"-8
CT50-B12-45	18.5	165.1	12.065	69.85	1"-8
CT50-B16-60	24	185.6	15.733	69.85	1"-8
CT50-B18-60	32	196.6	17.78	69.85	1"-8
CT50-B22-60	40.5	202.1	21.793	69.85	1"-8
CT50-B24-60	50.5	212.1	23.825	69.85	1"-8



Shandong Jinjie Machinery Co.,Ltd

Addr: 253000, #438, North Hubin Road, Tianqu Industrial Park, Dezhou, Shandong, China

Tel: +86-534-2356966 Fax: +86-534-2356966

Email: sales@jinjie-machinery.com; sophie@jinjie-machinery.com

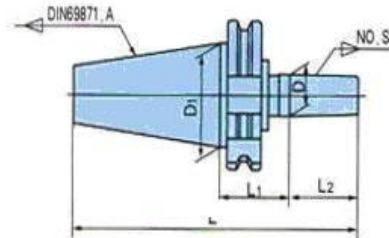
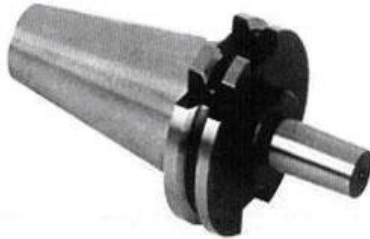

Model	L ₂	L	D	D ₁	Drawbar thread
DIN69871.A40-J0-32	11.112	111.5	6.35	44.45	M16
DIN69871.A40-J1-32	16.669	117	9.754	44.45	M16
DIN69871.A40-J2-32	22.225	122.6	14.199	44.45	M16
DIN69871.A40-J2S-32	19.05	119.5	13.94	44.45	M16
DIN69871.A40-J3-32	30.956	131.4	20.599	44.45	M16
DIN69871.A40-J4-32	42.069	142.5	28.55	44.45	M16
DIN69871.A40-J5-32	47.625	148	35.89	44.45	M16
DIN69871.A40-J6-32	25.4	125.8	17.17	44.45	M16
DIN69871.A40-J33-32	25.4	128.8	15.85	44.45	M16
DIN69871.A40-B6-32	10	110.4	6.35	44.45	M16
DIN69871.A40-B10-32	14.5	114.9	10.094	44.45	M16
DIN69871.A40-B10-45	14.5	127.9	10.094	44.45	M16
DIN69871.A40-B12-32	18.5	118.9	12.065	44.45	M16
DIN69871.A40-B12-80	18.8	166.9	12.065	44.45	M16
DIN69871.A40-B16-26	24	118.4	15.733	44.45	M16
DIN69871.A40-B16-32	24	124.4	15.733	44.45	M16
DIN69871.A40-B16-45	24	137.4	15.733	44.45	M16
DIN69871.A40-B18-32	32	132.4	17.78	44.45	M16
DIN69871.A40-B18-45	32	145.4	17.78	44.45	M16
DIN69871.A40-B22-32	40.8	140.9	21.793	44.45	M16
DIN69871.A40-B24-32	50.5	150.9	23.825	44.45	M16
DIN69871.A50-B16-45	24	170.75	15.733	69.85	M24
DIN69871.A50-J3-45	30.965	177.7	20.599	69.85	M16
DIN69871.A50-J6-45	25.4	172.1	17.17	69.85	M16
DIN69871.A50-J33-45	25.4	172.1	15.85	69.85	M16
DIN69871.A50-B16-45	24	170.8	15.733	69.85	M16
DIN69871.A50-B18-45	32	178.8	17.78	69.85	M16
DIN69871.A50-B22-60	40.5	202.3	21.793	69.85	M24
DIN69871.A50-B24-60	50.5	212.3	23.825	69.85	M24